

Ghost

Design by Arik Levy

A study in contrasts, the Ghost collection embodies both spirit and materiality, discretion and presence. A contemporary reimagining of the grand lights that once graced entryways and living areas, its sensuous form radiates a welcoming, luminous sensitivity.

Table



Ø 47,5 cm

4960



Ø 47,5 cm

4965



Ø 47,5 cm

4970

A colour glass diffuser can be placed in the lower glass for an amber or burgundy light effect



Dimming and installation options



/15: Push-dimming model equipped with two buttons, one for each diffuser. A quick push turns the light on and off, a longer presson dims the light.

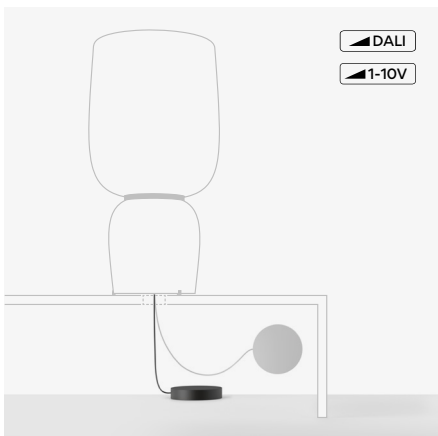

Dimming and installation options: The driver of the DALI, 1-10V and Casambi versions is enclosed in a box at the end of the cable.

4960

Finishes
 ● 11/ __ Black (NCS S 8500-N)

LED temperature colour
 /1_ 2700 K CRI >90 5432,0 lm 137 lm/W

Control
 4960 __ / _ 1 DALI

4960 __ / _ 3 1-10V

4960 __ / _ 5 Push

4960 __ / _ Z Casambi

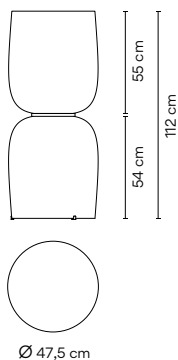

Materials
 Diffuser: Opal Glass.
 Metal parts: Aluminum.

Light Source and electronics
 2 x LED 19,8 W 800 mA
 Constant Current 800 mA
 100~240V 50/60Hz

Packaging
 2 Boxes
 Total Vol 0,6051 m³
 Gross weight 25,7 Kg Net weight 22,7 Kg

Notes
 A colour glass diffuser can be placed in the lower glass for an amber or burgundy light effect. Electric cable 2 m.
 Extra cable length.

LED IP20 CE E Dimmer Bi-volt

4965

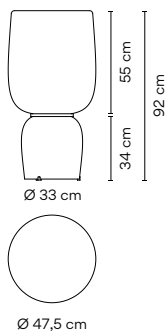

Finishes
 ● 11/ __ Black
 (NCS S 8500-N)

LED temperature colour
 /1_ 2700 K 
 CRI >90 5432,0 lm 137 lm/W

Control
 4965 __ / _ 1
 DALI
 4965 __ / _ 3
 1-10V
 4965 __ / _ 5
 Push
 4965 __ / _ Z
 Casambi

Materials
 Diffuser: Opal Glass.
 Metal parts: Aluminum.

Light Source and electronics
 2 x LED 19,8 W 800 mA
 Constant Current 800 mA
 100~240V 50/60Hz

Packaging
 2 Boxes
 Total Vol 0,6051 m³
 Gross weight 20,6 Kg Net weight 17,6 Kg

Notes
 A colour glass diffuser can be placed in the lower glass for an amber or burgundy light effect. Electric cable 2 m.
 Extra cable length.



4970

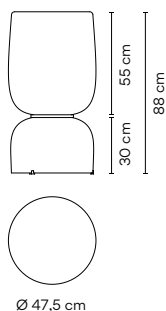

Finishes
 ● 11/ __ Black
 (NCS S 8500-N)

LED temperature colour
 /1_ 2700 K 
 CRI >90 5432,0 lm 137 lm/W

Control
 4970 __ / _ 1
 DALI
 4970 __ / _ 3
 1-10V
 4970 __ / _ 5
 Push
 4970 __ / _ Z
 Casambi

Materials
 Diffuser: Opal Glass.
 Metal parts: Aluminum.

Light Source and electronics
 2 x LED 19,8 W 800 mA
 Constant Current 800 mA
 100~240V 50/60Hz

Packaging
 2 Boxes
 Total Vol 0,6051 m³
 Gross weight 21,7 Kg Net weight 18,7 Kg

Notes
 A colour glass diffuser can be placed in the lower glass for an amber or burgundy light effect. Electric cable 2 m.
 Extra cable length.



Pendants



4987

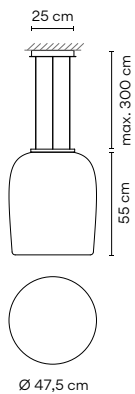

Finishes
 ● **11/ _ _ Black**
 (NCS S 8500-N)

LED temperature colour
 /1_ 2700 K
 CRI >90 4826,7 lm 130 lm/W

Control
4987 _ _ / _ A
 DALI-2, 1-10V, Push
4987 _ _ / _ Z
 Casambi

Materials
 Diffuser: Opal Glass.
 Metal parts: Aluminum.

Light Source and electronics
 1 x LED 37,2 W 1050 mA
 Constant Current 1050 mA
 100~240V 50/60Hz

Packaging
 1 Box 0,61 x 0,62 x 0,80 m
 Vol 0,3026 m³
 Gross weight 13,9 Kg Net weight 12,4 Kg
 Extra cable length.

LED IP20 CE Dimmer Bi-volt